

# Vue explosée de la EXPERT-102

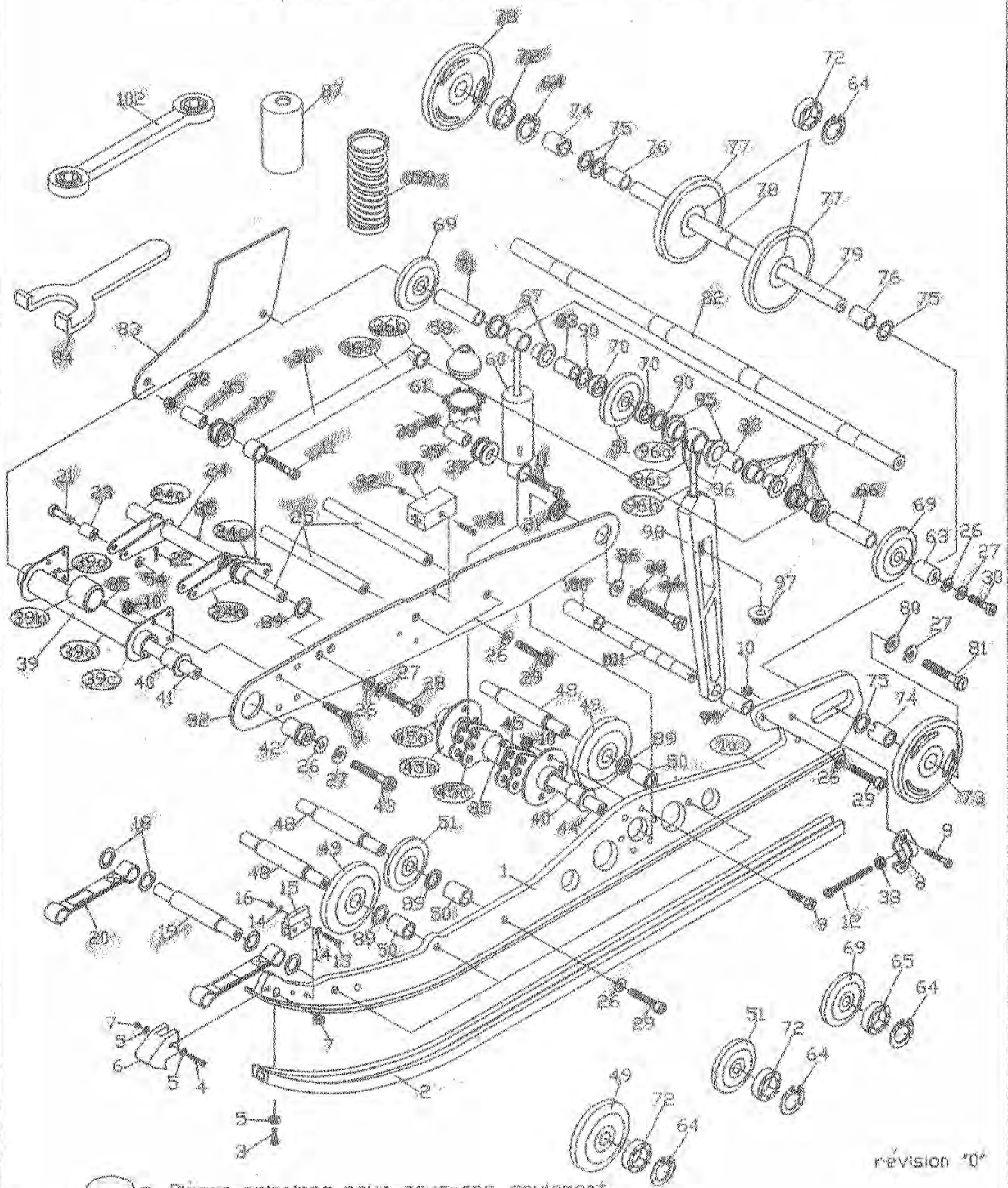

révision '0'

## EXPERT-102 / PARTS LIST

revision "0"

ref. no.	Part number (P/N)	Description	Qty/susp.
1	001-SA	RUNNER	2
2	04-218-22	SLIDER SHOE	2
3	22204AI	BOTTON HEAD S.S. M6 X 20	2
4	053.6.50	HEX. SCREW M6 X 50	2
5	407.6	WASHER 6 MM	4
6	025-00	RUNNER PROTECTOR	2
7	368.6	HEX. ELASTIC NUT M6	4
8	503-1401-00	TENSIONNER	2
9	057.8.25	HEX. SCREW M8 X 25	20
10	368.8	HEX. ELASTIC NUT M8	19
11	053.10.45	HEX. SCREW M10 X 45	3
12	057.10.110	HEX. SCREW M10 X 110 (FULL THREAD)	2
13	057.5.40	HEX. SCREW M5 X 40	6
14	407.5	WASHER 5 MM	12
15	570-0479-00	FRONT RUBBER STOPPER	2
16	368.5	HEX. ELASTIC NUT M5	6
17	570-0630-00	REAR RUBBER STOPPER	2
18	95611A036	PLASTIC WASHER 13/16 I.D. X 1 1/2 O.D. X 3/32	4
19	001-00	AXLE	1
20	002-00	STOPPER STRAP	2
21	999.516.158	CLEVIS PIN 5/16" X 1 5/8"	2
22	471.332.34	COTTER PIN 3/32" X 3/4"	2
23	003-00	SPACER	2
24	002-SA	"DTR" ARM PIVOT	1
25	004-00	SWING ARM SPACER	3
26	410.38	HIGH STRENGTH WASHER 3/8"	18
27	441.10	SPRING LOCK WASHER 10 MM	8
28	057.10.30	HEX. SCREW M10 X 30	2
29	084.10.30	ALLEN SCREW M10 X 30	14
30	SEE TABLE 1	page 4	
31	005-00	TRUST BUSHING	2
32	006-00	SWING ARM SIDE PLATE	2
33	442.12	SPRING LOCK WASHER 1/2"	2

34	057.12.40	HEX. SCREW M12 X 40	2
35	503-1637-00	SPACER	3
36	003-SA	"DTR" ROD	1
37	414-9423-00	CUSHION	3
38	368.10	HEX. ELASTIC NUT M10	5
39	004-SA	SWING ARM FRONT AXLE	1
40	SF-2836-24	BUSHING OIL LITE	4
41	007-00	SWING ARM FRONT SHAFT	1
42	SEE TABLE 1	page 4	
43	SEE TABLE 1	page 4	
44	009-00	SWING ARM LOWER SHAFT	1
45	005-SA	SWING ARM LOWER AXLE	1
48	010-00	WHEEL AXLE	3
49	04-116-66	IDLER WHEEL 5.350" + #6205 + CIRCLIP	4
50	023-00	SPACER	6
51	25-020-20	IDLER WHEEL 4.000" + # 6205 + CIRCLIP	3
54	410.516	HIGH STRENGTH WASHER 5/16"	4
58	013-00	SPRING STOPPER	2
59	C-375-2650-10650	SPRING 185/450	2
60	414-9535-00	SHOCK ABSORBER	2
61	414-7626-00	SPRING SEAT	2
63	SEE TABLE 1	page 4	
64	04-116-100	CIRCLIP	2
65	04-152-02OR	BEARING # 6304 (SPARE PARTS ONLY)	0
66	015-00	SPACER	1
67	016-00	BUSHING SAE-660 (MACHINED)	6
69	25-021-20	IDLER WHEEL 4.000" + # 6304 + CIRCLIP	2
70	018-00	SPACER	2
71	019-00	SPACER	1
72	B-6205NS6	BEARING # 6205	2
73	570-0453-21	IDLER WHEEL 165 MM	2
74	503-1397-00	OUTER SPACER	2
75	504-1082-00	SHIM	4
76	503-1396-00	SHORT SPACER	2
77	572-0458-00	IDLER PLASTIC WHEEL 165 MM+ #6205+CIRCLIP	2
78	503-1560-00	LONG SPACER	1

79	020-00	REAR AXLE	1
80	503-1710-00	WASHER 10 MM (special)	2
81	732-6010-02	SCREW M10 (special)	2
82	021-00	UPPER AXLE	1
83	022-00	SIDE FRAME DOUBLER	2
84	529-0190-00	WRENCH ADJUSTER	1
85	987.14.10	GREASE FITTING 1/4-NF	3
86	410.12	HIGH STRENGTH WASHER 1/2"	2
87	517-2809-00	PROTECTOR	2
89	BR14L	SHIM 7/8" I.D. X 1.375" O.D. X 18 GA.(0.045")	8
90	BR16L	SHIM 1" I.D. X 1.500" O.D. X 18 GA.	2
91	033.10.114	METAL SCREW ZINC 10-32 X 1 1/4" UNF	2
92	374.10.32	HEX. ELASTIC NUT 10-32	2
93	027-00	SPACER	2
95	028-00	BUSHING SAE-660 (MACHINED)	2
96	029-SA	ADJUSTABLE SOFTNESS ROD ASS'Y	1
97	173-12460-120-001	FLANGED ELASTIC NUT M12 X 1,75	1
98	030-00	SOFTNESS BAR	1
99	031-00	SPACER HYPALON 1" O.D. X 3/4" I.D. X 3.125"	1
100	032-00	SPACER HYPALON 1" O.D. X 3/4" I.D. X 4.125"	1
101	033-00	SOFTNESS AXLE	1
102	VT1186M	SOFTNESS ADJUSTING KEY	1
1A	001-01	RAIL PLATE	2
24A	002-01	TUBE MEC. 1.125 O.D. X 0.907 I.D.	1
24B	002-02	LONG YOKE PLATE	4
24C	002-03	SHORT YOKE PLATE	2
30A	053.10.45	HEX. SCREW M10 X 45	2
30B	053.10.55	HEX. SCREW M10 X 55	2
30C	053.10.50	HEX. SCREW M10 X 50	2
36A	003-01	TUBE MEC. 0.625 O.D. X 0.435 I.D.	1
36B	003-02	TUBE MEC. 1.250 O.D. X 1.010 I.D.	2
39A	004-01	TUBE MEC. 1.375 O.D. X 1.125 I.D.	1
39B	004-02	TUBE 1.625 O.D. X 0.120 WALL	1
39C	004-03	SQUARE PLATE	2
39D	004-04	GUSSET	2
42A	008-00	SWING ARM FRONT AXLE ADAPTOR	2

42B	008-01	SWING ARM FRONT AXLE ADAPTOR	2
42C	008-02	SWING ARM FRONT AXLE ADAPTOR	2
42D	008-03	SWING ARM FRONT AXLE ADAPTOR	2
42E	008-04	SWING ARM FRONT AXLE ADAPTOR	2
43A	053.10.80	HEX. SCREW M10 X 80	2
43B	053.10.90	HEX. SCREW M10 X 90	2
43C	053.10.85	HEX. SCREW M10 X 85	2
45A	005-01	TUBE MEC. 1.375 O.D. X 1.125 I.D.	1
45B	005-02	ROUND PLATE	2
45C	005-03	BEAR HAND PLATE	4
63A	014-00	UPPER AXLE ADAPTOR	2
63B	014-01	UPPER AXLE ADAPTOR	2
63C	014-02	UPPER AXLE ADAPTOR	2
63D	014-03	UPPER AXLE ADAPTOR	2
63E	014-04	UPPER AXLE ADAPTOR	2
96A	029-01	TUBE MEC. 1.500 O.D. X 1.125 I.D.	1
96B	029-02	ROUND ROD 9/16" THREADED	1
96C	029-03	STIFFENER 12 GA.	1

